

1999 Toyota RAV4
MAINTENANCE INFORMATION 1997-99 MAINTENANCE Toyota Maintenance Information

MAINTENANCE INFORMATION

1997-99 MAINTENANCE Toyota Maintenance Information

MODEL IDENTIFICATION

VIN LOCATION

The Vehicle Identification Number (VIN) is located on the left side of the dash panel at the base of the windshield. The VIN chart explains the code characters.

VIN CODE ID EXPLANATION

Numbers preceding the explanations in the legend below refer to the sequence of characters as listed on VIN identification label. See VIN example below.

1999 Toyota RAV4

MAINTENANCE INFORMATION 1997-99 MAINTENANCE Toyota Maintenance Information

VIN Code ID Explanation

(VIN)	J	T	3	D	B	0	2	T	0	T	0	0	4	9	5	0	6
	1	2	3	4	5	6	7	8	9	10	11	12	13	14	15	16	17
1 - Manufacturing Country	J	*															
2 - Manufacturer	T	*															
3 - Vehicle Type	3	*															
4 - Body Type/Drive Type	X	*															
	G	*															
	Y	*															
	H	*															
5 - Engine	P	*															
6 - Series	1	*															
7 - Restraint system/Grade	0	*															
8 - Car Line	V	*															
9 - VIN Check Digit	3	*															
10 - Vehicle Model Year	V	*															
	W	*															
	X	*															
11 - Assembly Plant	0-9	*															
	U	*															
12-17 - Serial Number	*																
	*																

Fig. 1: VIN Code ID Explanation

MAINTENANCE SERVICE INFORMATION

SEVERE & NORMAL SERVICE DEFINITIONS

Service is recommended at mileage intervals based on vehicle operation and engine type. Service schedules are based on the following primary operating conditions:

Light Service

- Light, non-commercial duty for distances greater than 5 miles in temperate climates above freezing and below 90°F (32°C).

1999 Toyota RAV4

MAINTENANCE INFORMATION 1997-99 MAINTENANCE Toyota Maintenance Information

Normal Service

- Driven More Than 10 Miles Daily
- No Operating Conditions From Severe Service Schedule

Severe Service (Unique Driving Conditions)

NOTE: Use the Severe Service schedule if the vehicle to be serviced is operated under ANY (one or more) of these conditions:

- Towing a trailer or using a camper or car-top carrier.
- Repeated short trips of less than 5 miles in temperatures below freezing.
- Extensive idling or low-speed driving for long distances as in heavy commercial use such as delivery, taxi or patrol car.
- Operating on rough, muddy or salt covered roads.
- Operating on unpaved or dusty roads.

CAMSHAFT TIMING BELT

Inspect timing belt at 60,000 miles or 48 months and thereafter inspect timing belt every 15,000 miles, or 12 months. Replace belt as necessary.

CAUTION: Failure to replace a faulty camshaft timing belt may result in serious engine damage.

The condition of camshaft drive belts should always be checked on vehicles which have more than 50,000 miles. Although some manufacturers do not recommend belt replacement at a specified mileage, others require it at 60,000-100,000 miles. A camshaft drive belt failure may cause extensive damage to internal engine components on most engines, although some designs do not allow piston-to-valve contact. These designs are often called Free Wheeling.

Many manufacturers changed their maintenance and warranty schedules in the mid-1980's to reflect timing belt inspection and/or replacement at 50,000-60,000 miles. Most service interval schedules in this manual reflect these changes.

Belts or components should be inspected and replaced if any of the following conditions exist:

- Cracks Or Tears In Belt Surface
- Missing, Damaged, Cracked Or Rounded Teeth
- Oil Contamination
- Damaged Or Faulty Tensioners
- Incorrect Tension Adjustment

SERVICE POINT LOCATIONS

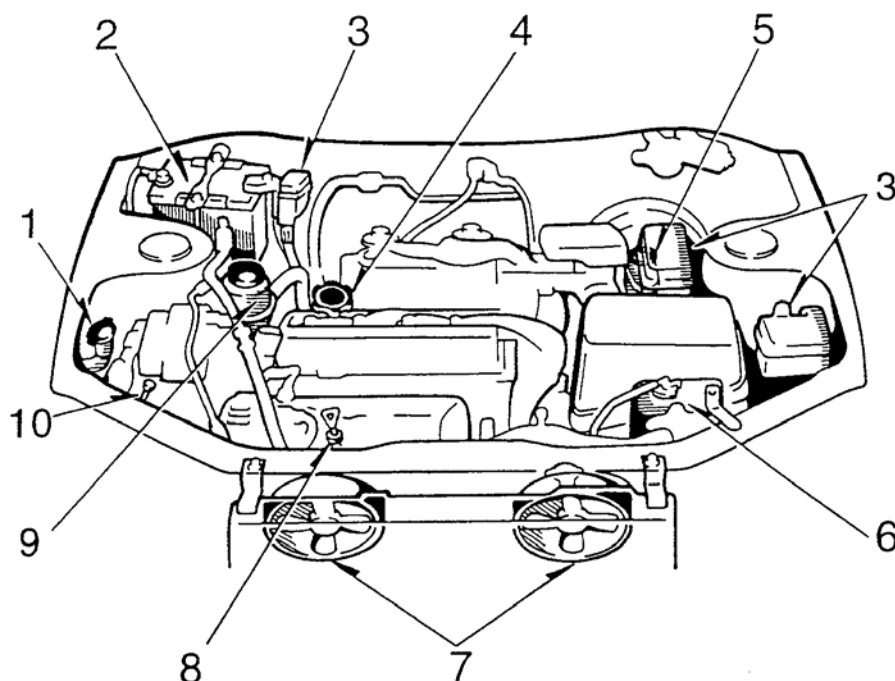

1. Windshield washer, rear window washer
fluid tank

2. Battery

3. Fuse blocks

4. Engine oil filler cap

5. Brake fluid reservoir

6. Engine coolant reservoir

7. Electric cooling fans

8. Engine oil level dipstick

9. Power steering fluid reservoir

10. Windshield washer fluid level dipstick

50A13086

Fig. 2: Service Point Locations

Courtesy of TOYOTA MOTOR SALES, U.S.A., INC.

1999 Toyota RAV4

MAINTENANCE INFORMATION 1997-99 MAINTENANCE Toyota Maintenance Information

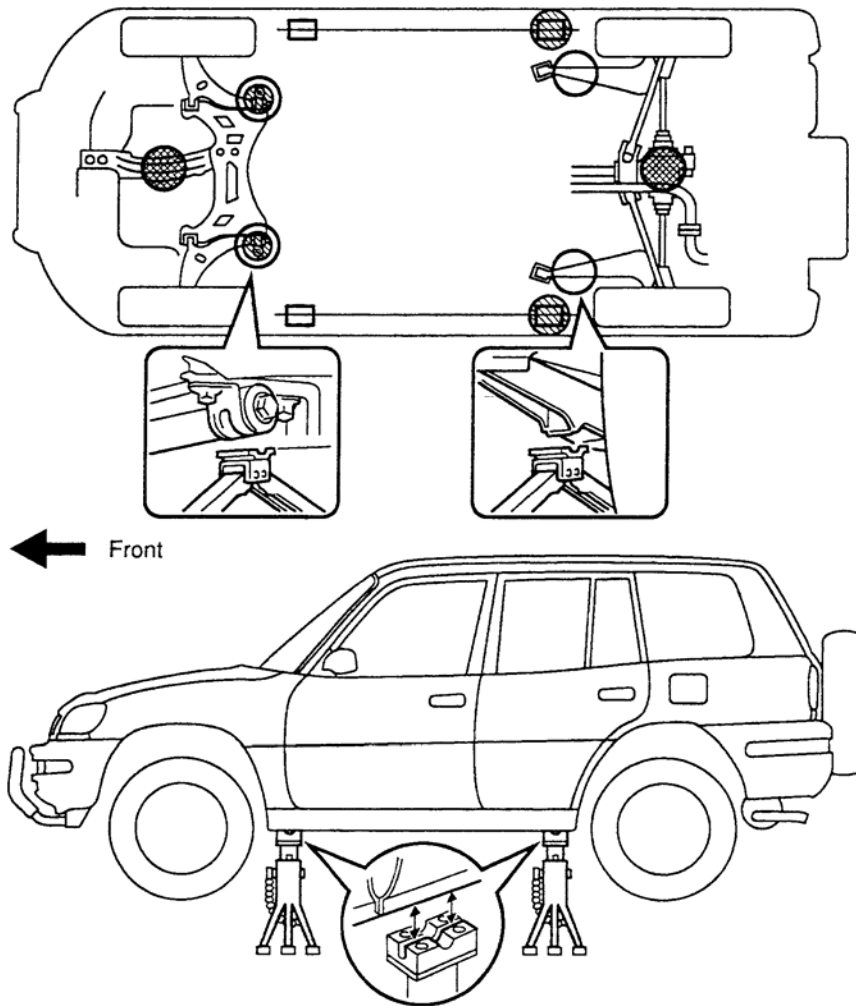

JACK POSITION

Front.....Front crossmember

Rear.....Rear differential carrier

CAUTION: Before jacking-up the rear and front, make sure the car is not carrying any extra weight.

PANTOGRAPH JACK POSITION

SUPPORT POSITION

Safety stand.....

Swing arm type lift.....

50B13087

Fig. 3: Lift Point Locations

Courtesy of TOYOTA MOTOR SALES, U.S.A., INC.

1999 Toyota RAV4

MAINTENANCE INFORMATION 1997-99 MAINTENANCE Toyota Maintenance Information

LUBRICATION SPECIFICATIONS

LUBRICATION SPECIFICATIONS

Material	Condition	Specification
Engine Oil	Ambient Temperature Less Than 50°F (10°C) to -20°F (-29°C)	SAE 5W-30 API SH
Engine Oil	Ambient Temperature Above 0°F (-18°C) to Over 100°F (38°C)	SAE 10W-30 API SH
Automatic Transaxle Fluid	2WD: All	ATF DEXRON II
Automatic Transaxle Fluid	4WD: All	ATF Type T or Equiv.
Manual Transaxle Fluid	All	API GL-4 or GL-5 SAE 75W-90
Clutch Fluid	All	DOT 3
Transfer Case Fluid	All	Multipurpose Gear Oil API GL-5, SAE 75W-90
Rear Differential Fluid	All	Hypoid Gear Oil API GL-5, SAE 90
Engine Coolant	All	Ethylene-Glycol Based
Power Steering Fluid	All	ATF DEXRON II
Brake Fluid	All	DOT 3

FLUID CAPACITIES

FLUID CAPACITIES

Item	Condition	Specification ⁽¹⁾
Engine Oil	Drained, With Filter	4.3 Qts. (4.1L)
Engine Oil	Drained, Without Filter	4.1 Qts. (3.9L)
Engine Coolant	M/T: Drained	8.5 Qts. (8.0L)
Engine Coolant	A/T: Drained	8.1 Qts. (7.7L)
Transfer Case Oil ⁽²⁾	Drained	0.7 Qts. (0.7L)
Automatic Transaxle Fluid	2WD: Drained	3.5 Qts. (3.3L)
Automatic Transaxle Fluid	4WD: Drained	7.4 Qts. (7.0L)
Manual Transaxle Oil	2WD: Drained	4.1 Qts. (3.9L)
Manual Transaxle Oil	4WD: Drained	5.3 Qts. (5.0L)
Rear Differential Oil ⁽³⁾	Drained	1.0 Qts. (0.9L)
Fuel Tank	Capacity	15.3 Gals. (58.0L)

(1) Capacities are recommended or calculated levels. Always use dipstick (if available) to measure level.

(2) 4WD models with an automatic transaxle.

(3) 4WD models, includes LSD.

BATTERY SPECIFICATIONS

CAUTION: When battery is disconnected, vehicles equipped with computers may lose memory data. When battery power is restored, driveability problems may exist on some vehicles. These vehicles may require a relearn procedure. See **COMPUTER RELEARN PROCEDURES** article in the **GENERAL INFORMATION** section.

If battery is replaced, it should be of the same group number as shown on original battery label.

CAUTIONS & WARNINGS

SUPPLEMENTAL RESTRAINT SYSTEM (AIR BAG)

WARNING: To avoid injury from accidental air bag deployment, read and carefully follow all warnings and service precautions. See appropriate **AIR BAG RESTRAINT SYSTEM** article in **ACCESSORIES/SAFETY EQUIPMENT**.

CAUTION: Disconnect negative battery cable before servicing any air bag system, steering column or passenger side dash component. After any repair, turn ignition key to the **ON** position from passenger's side of vehicle in case of accidental air bag inflation

NOTE: See the **AIR BAG RESTRAINT SYSTEM** article in the **ACCESSORIES/SAFETY EQUIPMENT** Section.

Modifications or improper maintenance, including incorrect removal and installation of the Supplemental Restraint System (SRS), can adversely affect system performance. **DO NOT** cover, obstruct or change the steering wheel horn pad in any way, as such action could cause improper function of the system. Use only plain water when cleaning the horn pad. Solvents or cleaners could adversely affect the air bag cover and cause improper deployment of the system.

AIR CONDITIONING SERVICING

CAUTION: Avoid breathing R-134a refrigerant and PAG lubricant vapors, exposure may irritate eyes, nose and throat. To remove R-134a from system use R-134a recycling equipment that meets SAE J2210 specifications. If accidental system discharge occurs, ventilate work area before resuming service.

WARNING: R-134a service equipment or vehicle A/C systems **SHOULD NOT** be pressure tested or leak tested with compressed air. Some mixtures of air/R134a have shown to be combustible at elevated pressures. These mixtures are dangerous and may cause fire and/or explosions. See **AIR CONDITIONING SERVICE** article in **GENERAL INFORMATION** section.

ANTI-LOCK BRAKE SYSTEM

CAUTION: The anti-lock brake system contains electronic equipment that can be susceptible to interference caused by improperly installed or high output radio transmitting equipment. Since this interference could cause the possible loss of the anti-lock braking capability, such equipment should be installed by qualified professionals.

On models equipped with anti-lock brake systems, ALWAYS observe the following cautions:

- DO NOT attempt to bleed hydraulic system without first referring to the appropriate ANTI-LOCK BRAKE SYSTEM article in the BRAKES Section.
- DO NOT mix tire sizes. As long as tires remain close to the original diameter, increasing the width is acceptable. Rolling diameter must be identical for all 4 tires. Some manufacturers recommend tires of the same brand, style and type. Failure to follow this precaution may cause inaccurate wheel speed readings.
- Use ONLY recommended brake fluids. DO NOT use silicone brake fluids in an ABS-equipped vehicle.

BATTERY WARNING

WARNING: When battery is disconnected, vehicles equipped with computers may lose memory data. When battery power is restored, driveability problems may exist on some vehicles. These vehicles may require a relearn procedure. See COMPUTER RELEARN PROCEDURES article in GENERAL INFORMATION section.

REPLACING BLOWN FUSES

CAUTION: Before replacing a blown fuse, remove ignition key, turn off all lights and accessories to avoid damaging the electrical system. Be sure to use fuse with the correct indicated amperage rating. The use of an incorrect amperage rating fuse may result in a dangerous electrical system overload.

BRAKE PAD WEAR INDICATOR

Indicator will cause a squealing or scraping noise, warning that brake pads need replacement.

CATALYTIC CONVERTER

CAUTION: Continued operation of vehicle with a severe malfunction could cause converter to overheat, resulting in possible damage to converter and vehicle.

CAUTION: Any modification to the exhaust system on turbo models, which reduces exhaust backpressure, will lead to lean fuel mixtures and excessive spark advance. This could cause serious engine damage.

1999 Toyota RAV4

MAINTENANCE INFORMATION 1997-99 MAINTENANCE Toyota Maintenance Information

ELECTROSTATIC DISCHARGE SENSITIVE (ESD) PARTS

WARNING: Many solid state electrical components can be damaged by static electricity (ESD). Some will display a warning label, but many will not. Discharge personal static electricity by touching a metal ground point on the vehicle prior to servicing any ESD sensitive component.

ENGINE OIL

CAUTION: Never use non-detergent or straight mineral oil.

FUEL SYSTEM SERVICE

WARNING: Relieve fuel system pressure prior to servicing any fuel system component (fuel injection models).

HALOGEN BULBS

WARNING: Halogen bulbs contain pressurized gas which may explode if overheated. DO NOT touch glass portion of bulb with bare hands. Eye protection should be worn when handling or working around halogen bulbs.

RADIATOR CAP

CAUTION: Always disconnect the fan motor when working near the radiator fan. The fan is temperature controlled and could start at any time even when the ignition key is in the OFF position. DO NOT loosen or remove radiator cap when cooling system is hot.

RADIATOR FAN

WARNING: Keep hands away from radiator fan. Fan is controlled by a thermostatic switch which may come on or run for up to 15 minutes even after engine is turned off.

WARRANTY INFORMATION

CAUTION: Due to the different warranties offered in various regions and the variety of after-market extended warranties available, please refer to the warranty package that came with the vehicle to verify all warranty options.

NEW VEHICLE LIMITED WARRANTY

1999 Toyota RAV4

MAINTENANCE INFORMATION 1997-99 MAINTENANCE Toyota Maintenance Information

Covers any repair or replacement of parts which becomes necessary due to defects in materials or workmanship under normal use for 36 months or 36,000 miles from in-service date.

The items specified below are covered for a period different from the basic coverage:

Air Conditioner

The air conditioner refrigerant charge is covered for the first 12 months, regardless of mileage, unless done as part of a warranty repair.

Adjustments

Service adjustment (minor repairs not usually associated with the replacement of parts) are covered for the first 12 months or 12,500 miles, whichever occurs first.

POWERTRAIN WARRANTY

Engine, transmission, front wheel drive, rear wheel drive and restraint system are warranted against defects in materials or workmanship under normal use for 5 years or 60,000 miles, whichever occurs first. See copy of warranty for specific components covered.

CORROSION PERFORATION WARRANTY

Covers any repair or replacement to body sheet metal which develops corrosion perforation (hole through panel), in normal use, due to defects in material or workmanship for a period of 5 years, regardless of mileage.

BATTERY WARRANTY

Covers replacement of defective original battery for first 12 months or 12,000 miles. After the first 12 months or 12,000 miles, warranty covers a pro-rated amount based on months in service, up to a maximum of 36 months.

EMISSION SYSTEM DEFECT WARRANTY (EXCEPT CALIFORNIA)

Warrants to the retail purchaser, and subsequent purchaser that vehicle was designed, built, and equipped so as to conform at the time of sale with applicable emission regulations and that it is free from defects in materials or workmanship which may cause the vehicle to fail to conform with applicable regulations for 5 years or 50,000 miles, whichever occurs first.

EMISSION SYSTEM PERFORMANCE WARRANTY (EXCEPT CALIFORNIA)

Covers all repairs, adjustments, or replacements if vehicle fails to conform to applicable emission standards and such failure results in the vehicle owner having to bear a penalty or other sanction under local, state or federal law for 5 years or 50,000 miles, whichever comes first. If the vehicle has been in use for more than 24 months or 24,000 miles, the manufacturer will make the necessary adjustments, repairs or replacements at no cost to the owner only when noncompliance is caused by failure of components which have been installed in the vehicle for the sole or primary purpose of reducing vehicle emissions. See copy of warranty for specific components

1999 Toyota RAV4
MAINTENANCE INFORMATION 1997-99 MAINTENANCE Toyota Maintenance Information

covered.

EMISSION SYSTEM PERFORMANCE WARRANTY (CALIFORNIA)

For a period of 3 years or 50,000 miles, manufacturer will make all necessary repairs and adjustments to ensure vehicle passes a required Smog Check inspection.

EMISSION SYSTEM DEFECT WARRANTY (CALIFORNIA)

Warrants vehicle to be free of defects in materials or workmanship that may cause it to fail to conform with applicable California emission regulations for a period of 5 years or 50,000 miles, whichever occurs first. Certain emission-related parts are covered for repair or replacement for 7 years or 70,000 miles, whichever occurs first. See copy of warranty for specific components covered.

FUSES & CIRCUIT BREAKERS

Fuse box is located below instrument panel to left of steering column on all vehicles. An additional fuse and relay box located in the engine compartment.

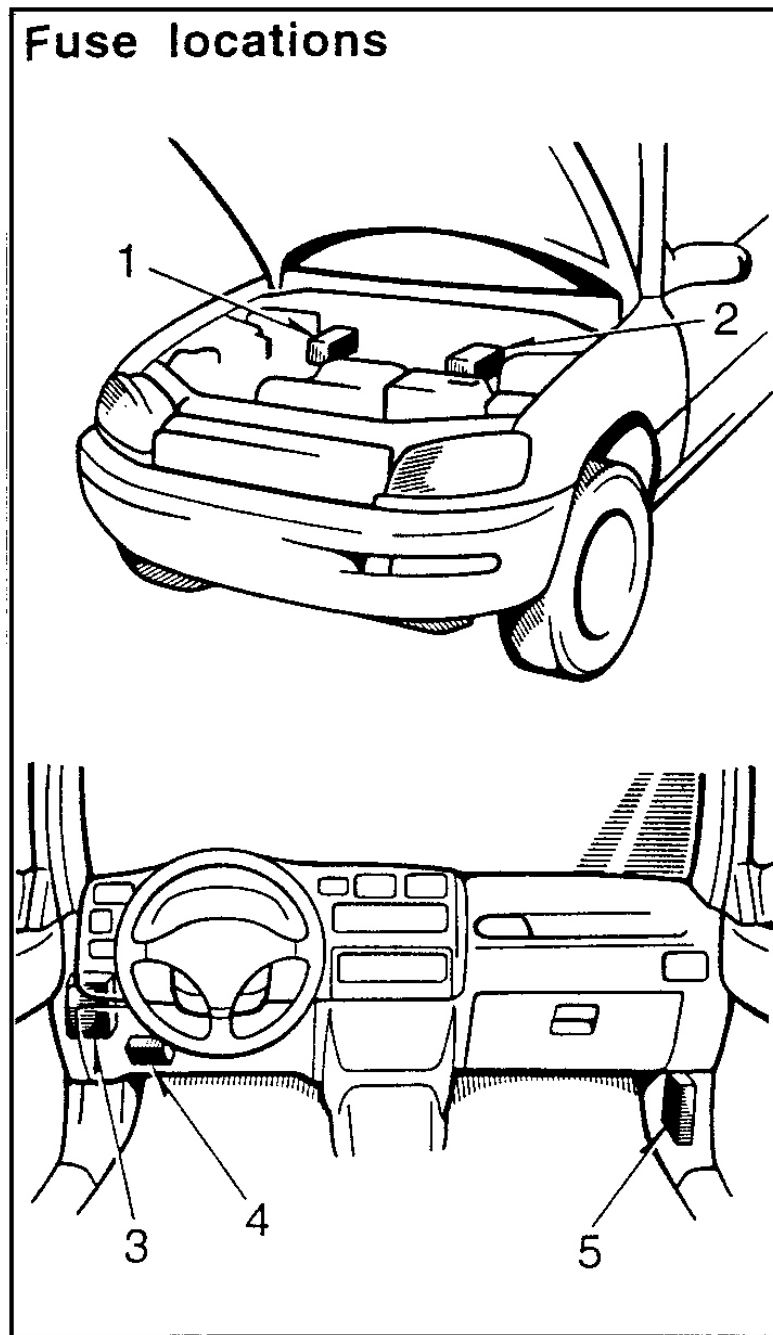

50C13088

Fig. 4: Fuse Block Locations - 1997

Courtesy of TOYOTA MOTOR SALES, U.S.A., INC.

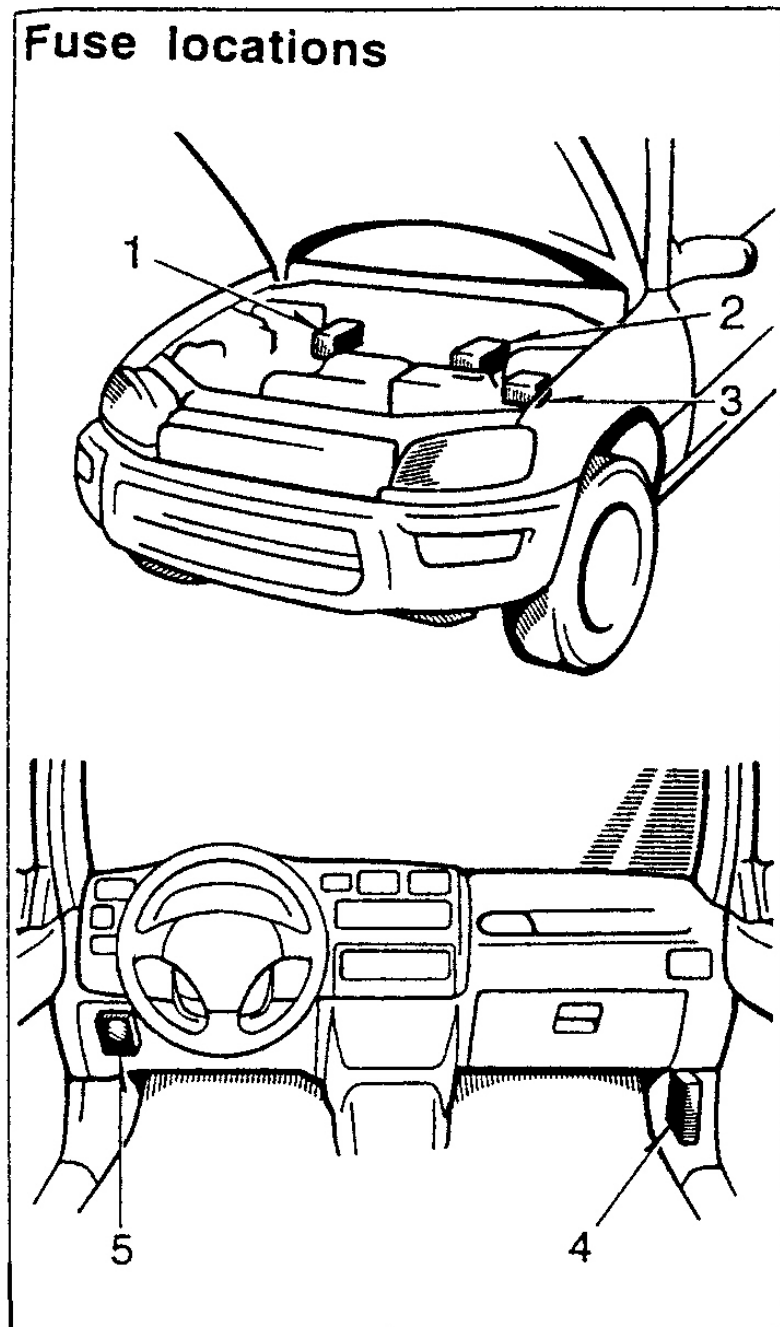

50D13089

Fig. 5: Fuse Block Locations - 1998
Courtesy of TOYOTA MOTOR SALES, U.S.A., INC.

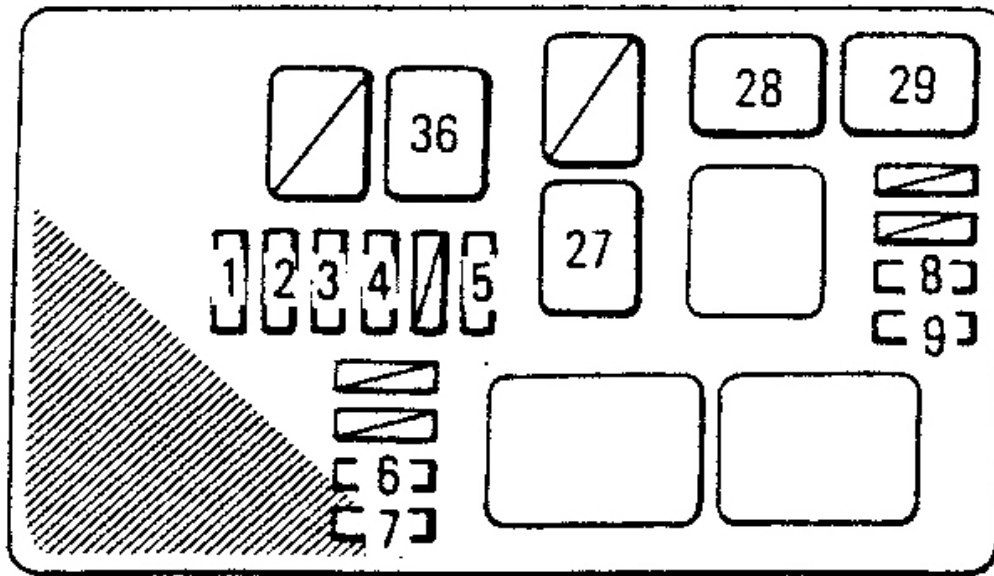

Engine compartment (U.S.A.)

50G13090

Fig. 6: Engine Compartment Fuse Box Identification (USA) - 1997

Courtesy of TOYOTA MOTOR SALES, U.S.A., INC.

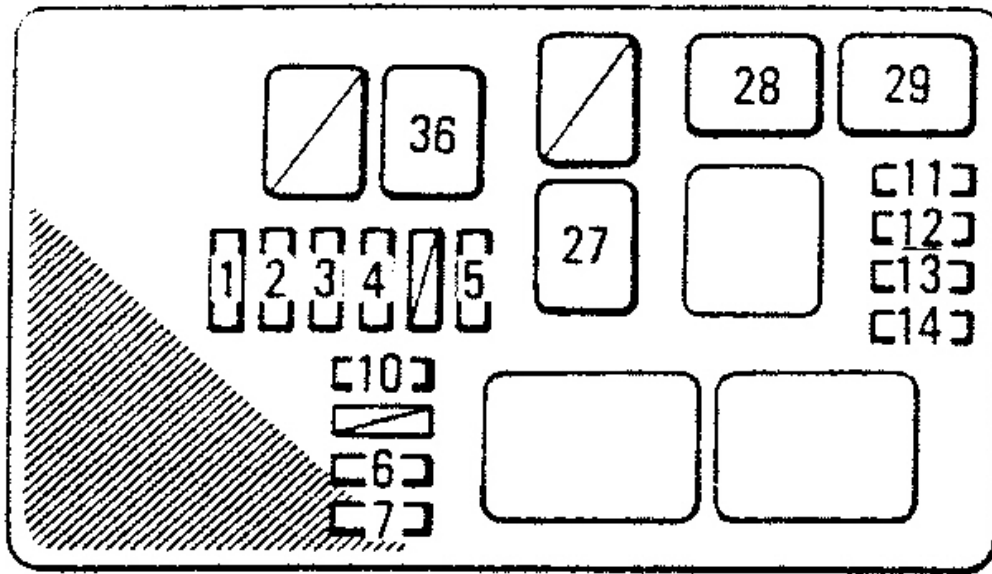

Engine compartment (Canada)

50H13091

Fig. 7: Engine Compartment Fuse Box Identification (Canada) - 1997
Courtesy of TOYOTA MOTOR SALES, U.S.A., INC.

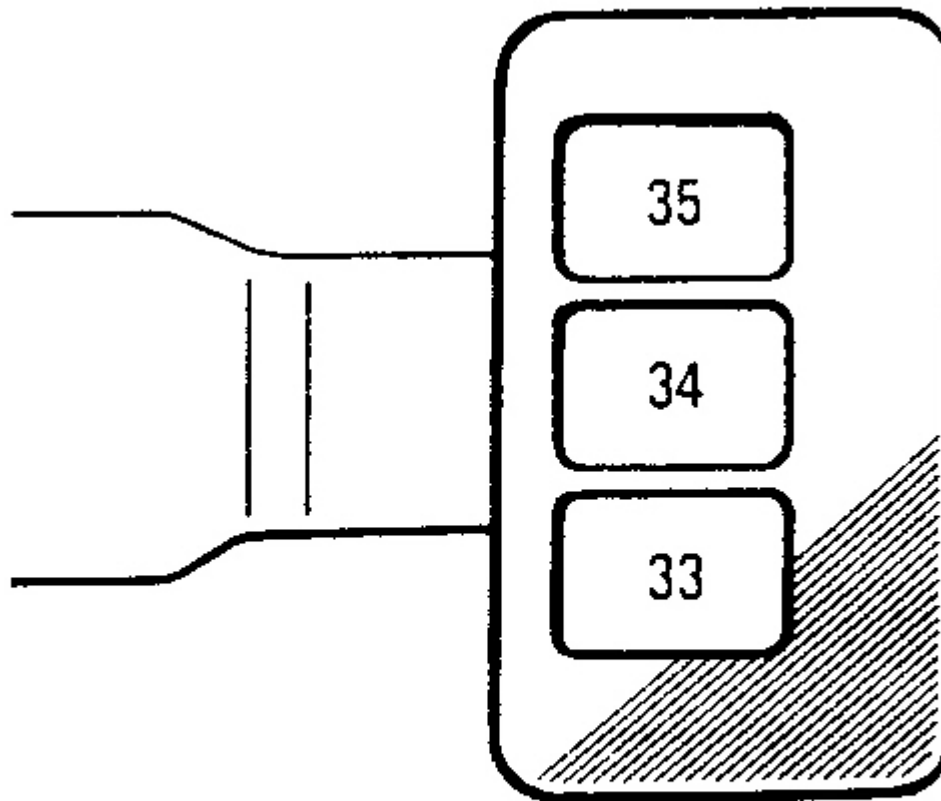

Engine compartment

50113092

Fig. 8: Engine Compartment Fuse Box Identification - 1997
Courtesy of TOYOTA MOTOR SALES, U.S.A., INC.

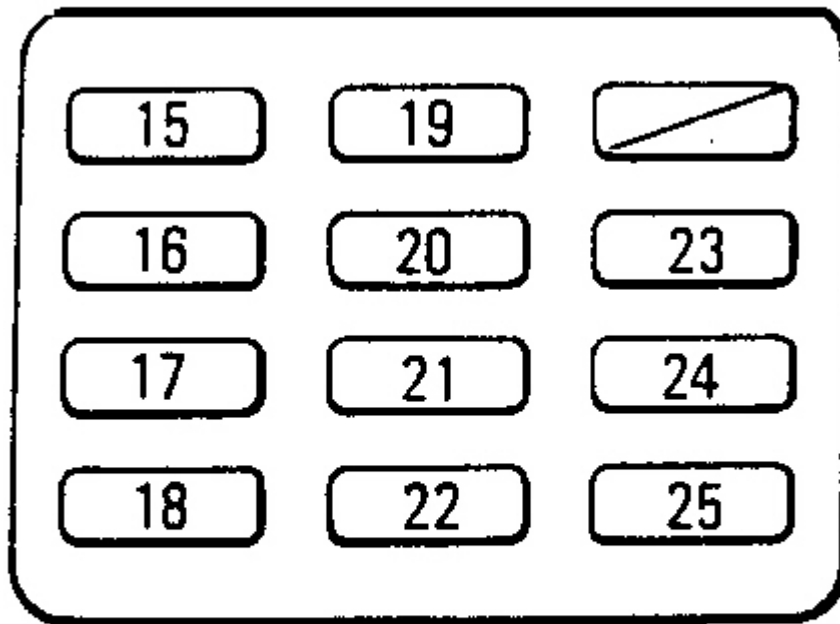

Instrument panel - upper

50J13093

Fig. 9: Instrument Panel Fuse Box Identification - Upper - 1997
Courtesy of TOYOTA MOTOR SALES, U.S.A., INC.

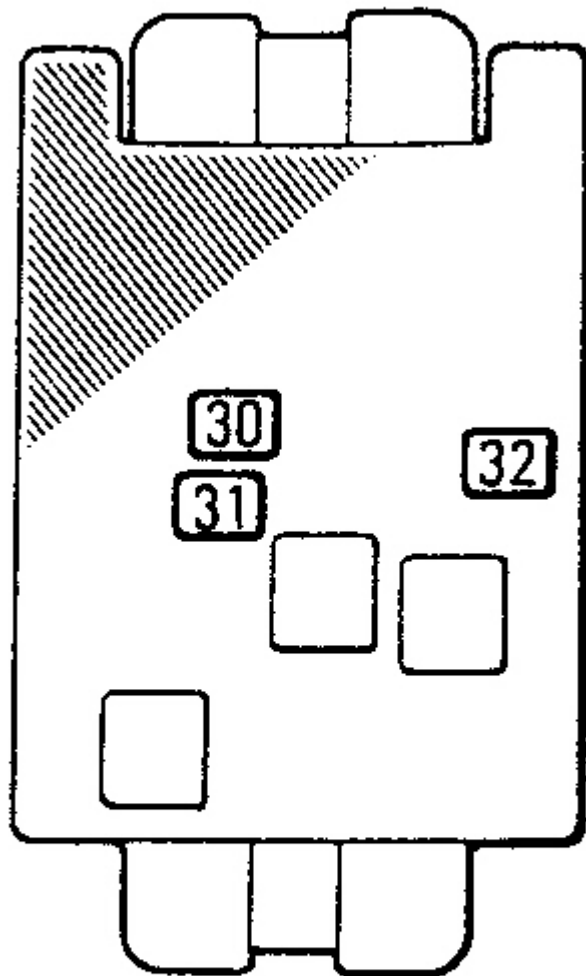

**Instrument panel
—lower**

50A13094

Fig. 10: Instrument Panel Fuse Box Identification - Lower - 1997
Courtesy of TOYOTA MOTOR SALES, U.S.A., INC.

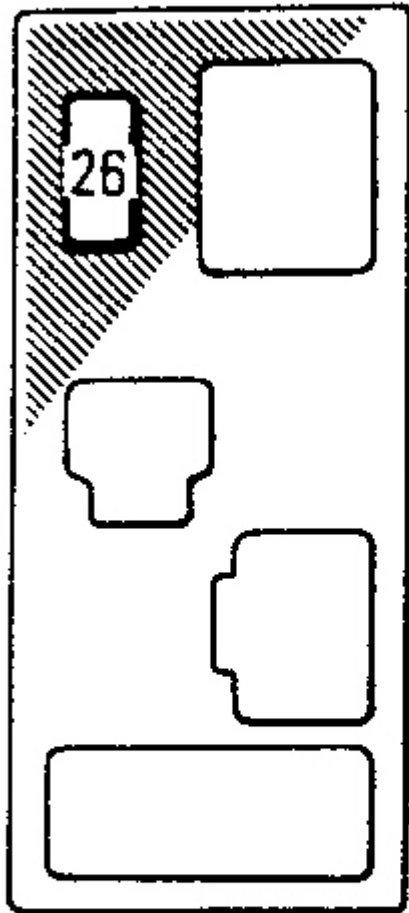

**Passenger's
side kick panel**

50B13095

Fig. 11: Passenger's Side Kick Panel Fuse Box Identification - 1997
Courtesy of TOYOTA MOTOR SALES, U.S.A., INC.

1999 Toyota RAV4

MAINTENANCE INFORMATION 1997-99 MAINTENANCE Toyota Maintenance Information

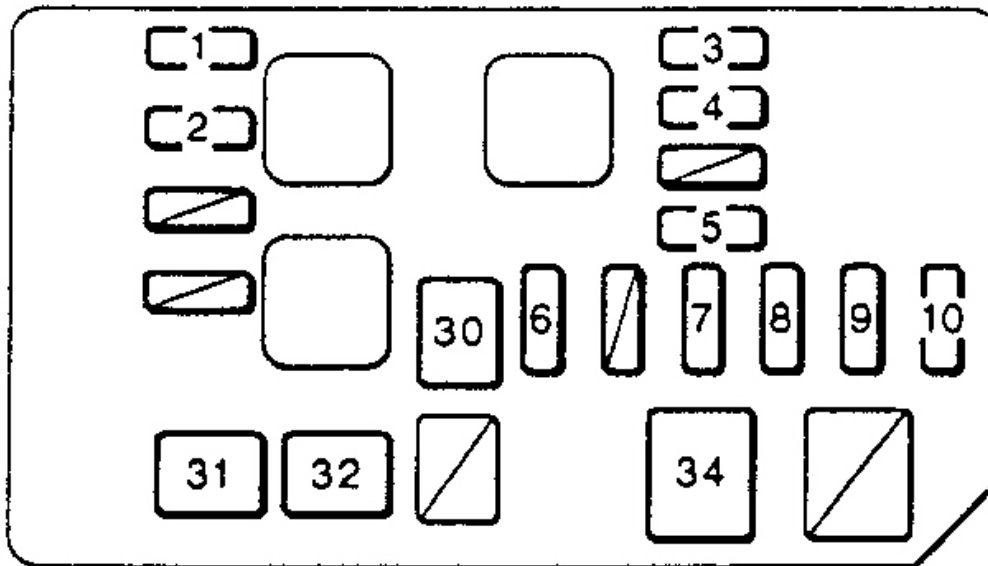

Engine compartment (U.S.A.)

50C13096

Fig. 12: Engine Compartment Fuse Box Identification (USA) - 1998
Courtesy of TOYOTA MOTOR SALES, U.S.A., INC.

1999 Toyota RAV4

MAINTENANCE INFORMATION 1997-99 MAINTENANCE Toyota Maintenance Information

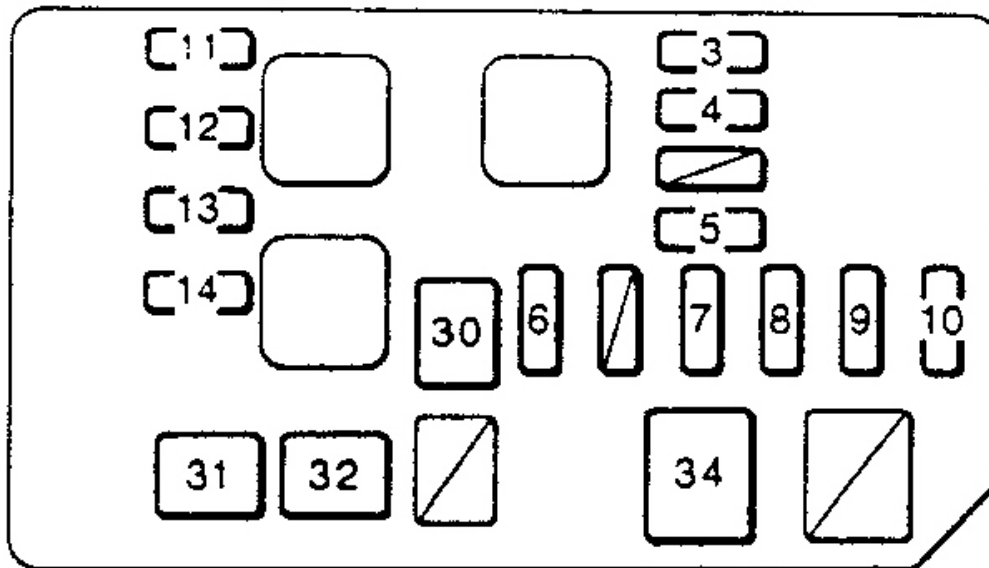

Engine compartment (Canada)

50D13097

Fig. 13: Engine Compartment Fuse Box Identification (Canada) - 1998
Courtesy of TOYOTA MOTOR SALES, U.S.A., INC.

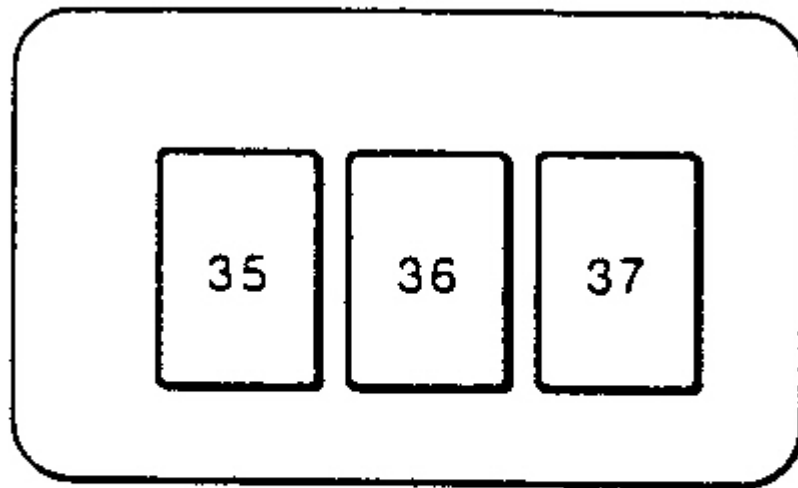

Engine compartment

50E13098

Fig. 14: Engine Compartment Fuse Box Identification - 1998
Courtesy of TOYOTA MOTOR SALES, U.S.A., INC.

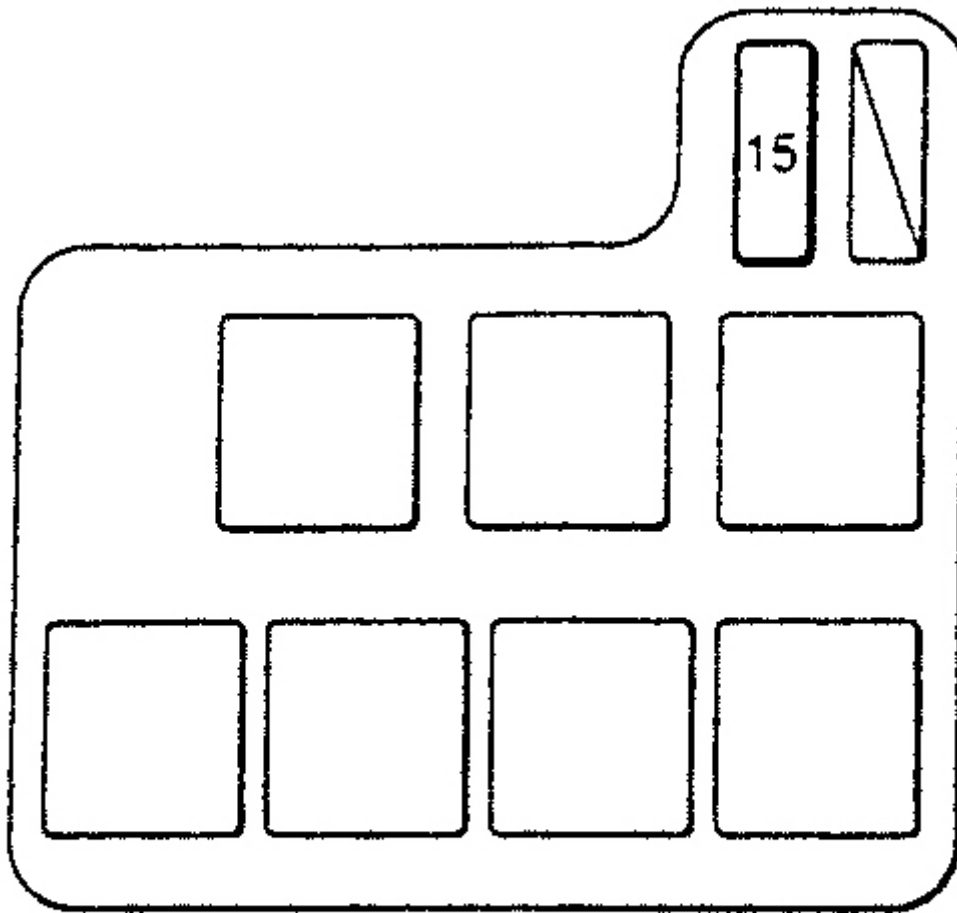

Instrument panel

50F13099

Fig. 15: Driver's Side Kick Panel Fuse Identification - 1998
Courtesy of TOYOTA MOTOR SALES, U.S.A., INC.

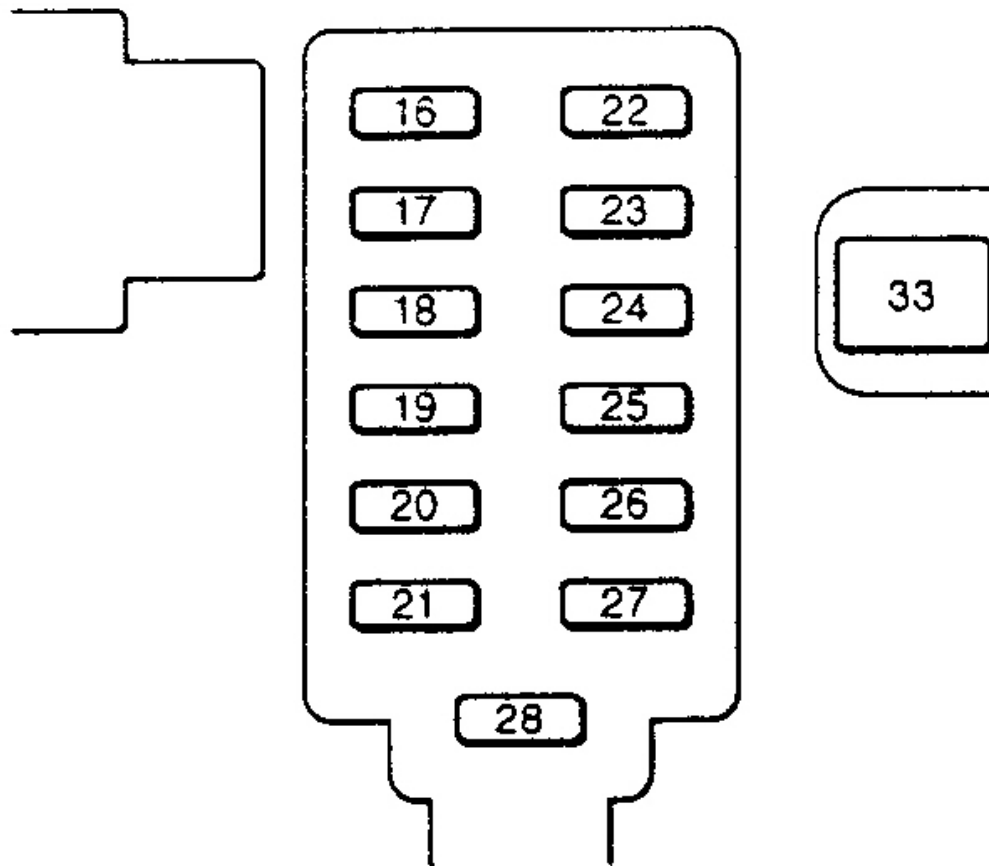

Instrument panel

50113100

Fig. 16: Instrument Panel Fuse Box Identification - 1998
Courtesy of TOYOTA MOTOR SALES, U.S.A., INC.

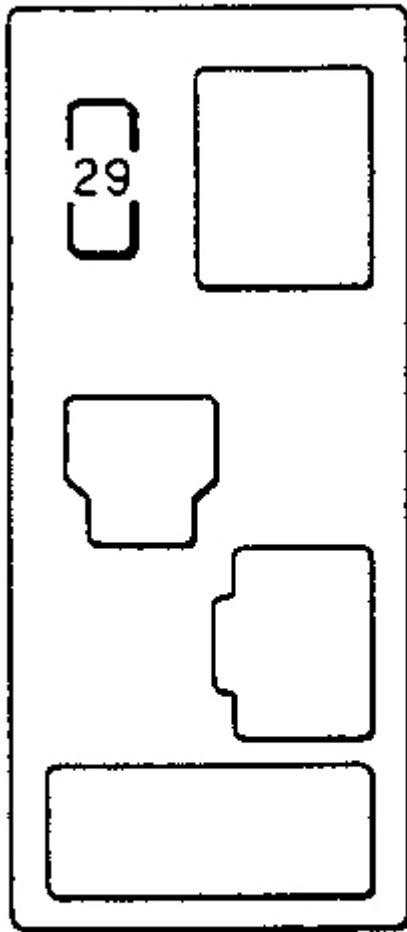

**Passenger's
side kick panel**

50J13101

Fig. 17: Passenger's Side Kick Panel Fuse Box Identification - 1998
Courtesy of TOYOTA MOTOR SALES, U.S.A., INC.

Fuse & Circuit Breaker Identificatio - 1997

- **1 - AM2 10 Amp** Multiport Fuel Injection System/Sequential Multiport Fuel Injection System, Charging

1999 Toyota RAV4

MAINTENANCE INFORMATION 1997-99 MAINTENANCE Toyota Maintenance Information

System

- **2 - DOME 15 Amp** Personal Lights, Open Door Warning Light, Clock
- **3 - EFI 15 Amp** Multiport Fuel Injection System/Sequential Multiport Fuel Injection System
- **4 - HAZ-HORN 15 Amp** Emergency Flashers, Horns
- **5 - ALT-S 5 Amp** Charging system
- **6 - SPARE 15 Amp** Spare fuse
- **7 - SPARE 7.5 Amp** Spare fuses
- **8 - H-LP (LH) 15 Amp** Left-Hand Headlight
- **9 - H-LP (RH) 15 Amp** Right-Hand Headlight
- **10 - DRL 7.5 Amp** Daytime Running Light System
- **11 - H-LP LH-L 10 Amp** Left Hand Headlight (Low Beam)
- **12 - H-LP RH-L 10 Amp** Right Hand Headlight (Low Beam)
- **13 - H-LP LH-H 10 Amp** Left Hand Headlight (High Beam)
- **14 - H-LP RH-H 10 Amp** Right Hand Headlight (High Beam)
- **15 - TAIL 10 Amp** Tail Lights, Parking Lights, License Plate Lights, Interior Lights
- **16 - GAUGE 10 Amp** Gauges And Meters, Service Reminder Indicators (Except Discharge And Open Door Warning Lights), Back-up Lights, Air Conditioning System, Power Windows, Rear Window Defogger, Center Differential Lock System, Electronically Controlled Automatic Transaxle System
- **17 - TURN 7.5 Amp** Turn Signal Lights
- **18 - CIG & RAD 15 Amp** Cigarette Lighter, Clock, Car Audio System, Power Rear View Mirrors
- **19 - DEF-I/UP 7.5 Amp** Multiport Fuel Injection System/Sequential Multiport Fuel Injection System
- **20 - IGN 7.5 Amp** Multiport Fuel Injection System/Sequential Multiport Fuel Injection System, Discharge Warning Light
- **21 - ECU-IG 7.5 Amp** Anti-Lock Brake System, Electronically Controlled Automatic Transmission System
- **22 - WIPER 20 Amp** Windshield Wipers And Washer, Rear Window Wiper And Washer
- **23 - SRS 7.5 Amp** SRS Airbag System
- **24 - OBD 7.5 Amp** On-Board Diagnostic System
- **25 - STOP 10 Amp** Stop Lights
- **26 - A/C 7.5 Amp** Air Conditioning System
- **27 - MAIN No. 1 30 Amp** Starting System, Headlights
- **28 - RDI FAN 30 Amp** Electric Cooling Fan
- **29 - CDS FAN 30 Amp** Electric Cooling Fan
- **30 - POWER 30 Amp** Power Windows, Power Door Lock System
- **31 - DEF 30 Amp** Rear Window Defogger
- **32 - AM 1 40 Amp** CIG & RAD, WIPER, GAUGE, ECU-IG, TURN, TAIL, and PANEL fuses
- **33 - MAIN 80 Amp** AM 2, HAZ-HORN, EFI, DOME, RADIO and ALT-S fuses
- **34 - ALT 100 Amp** Tail lights, ABS, RADIO, HTR, AM 1, POWER, STOP and DEF fuses

1999 Toyota RAV4

MAINTENANCE INFORMATION 1997-99 MAINTENANCE Toyota Maintenance Information

- **35 - HTR 50 Amp** Air Conditioning system
- **36 - ABS 60 Amp** Anti-Lock brake system

Fuse & Circuit Breaker Identification - 1998

- **1 - H-LP (LH) 15 Amp** Left-Hand Headlight
- **2 - H-LP (RH) 15 Amp** Right-Hand Headlight
- **3 - SPARE 10 Amp** Spare fuse
- **4 - SPARE 15 Amp** Spare fuse
- **5 - AM2 5 Amp** Multiport Fuel Injection System/Sequential Multiport Fuel Injection System, SRS Airbag System, Seat Belt Pretensioners, Starting System, Discharge Warning Light
- **6 - ALT-S 5 Amp** Charging system
- **7 - HAZ 10 Amp** Emergency Flashers
- **8 - EFI 20 Amp (USA) or 15 Amp (Canada)** Multiport Fuel Injection System/Sequential Multiport Fuel Injection System
- **9 - DOME 15 Amp** Personal Lights, Open Door Warning Light, Clock
- **10 - IGN 20 Amp** Charging System
- **11 - H-LP LH-H 10 Amp** Left Hand Headlight (High Beam)
- **12 - H-LP RH-H 10 Amp** Right Hand Headlight (High Beam)
- **13 - H-LP LH-L 10 Amp** Left Hand Headlight (Low Beam)
- **14 - H-LP RH-L 10 Amp** Right Hand Headlight (Low Beam)
- **15 - SEAT-HTR 10 Amp** No Circuit
- **16 - PWR OUTLET 15 Amp** Power Outlet
- **17 - CIG 15 Amp** Cigarette Lighter, Clock, Car Audio System, Power Rear View Mirrors, Electronically Controlled Automatic Transmission
- **18 - SRS-SCC 10 Amp** SRS Airbag System, Seat Belt Pretensioners
- **19 - WIPER 20 Amp** Windshield Wipers And Washer, Rear Window Wiper And Washer
- **20 - ECU-IG 10 Amp** Electronically Controlled Automatic Transmission System, Rear Window Defogger, Center Differential Lock System, Electric Moon Roof, Multiport Fuel Injection System, Electric Cooling Fan, Anti-Lock Brake System, Cruise Control System
- **21 - TURN & GAUGE 10 Amp** Turn Signal Lights, Gauges & Meters, Back-Up Lights, Service Reminder Indicators, Air Conditioning System, Daytime Running Light System
- **22 - STOP 10 Amp** Stop Lights, High Mounted Stop Light, Electronically Controlled Automatic Transmission System, Anti-Lock Brake System
- **23 - TAIL 15 Amp** Gauges & Meters, Emergency Flashers, Cigarette Lighter, Center Differential Lock System, Clock, Rear Window Defogger, Air Conditioning System, Electronically Controlled Automatic Transmission System, Car Audio System, Tail Lights, License Plate Lights, Parking Lights, Instrument Panel Light Control, Side Marker Lights
- **24 - OBD 10 Amp** On-Board Diagnosis System
- **25 - SRS-B 10 Amp** SRS Air Bag Warning Light

1999 Toyota RAV4

MAINTENANCE INFORMATION 1997-99 MAINTENANCE Toyota Maintenance Information

- **26 - HORN 10 Amp** Horn
- **27 - DEFOG 20 Amp** Rear Window Defogger
- **28 - DEF 30 Amp** Rear Window Defogger
- **29 - A/C 10 Amp** Air Conditioning System
- **30 - MAIN No. 1 40 Amp** Starting System, H-LP (RH), H-LP (LH), H-LP RH-H, H-LP LH-H, H-LP RH-L, H-LP LH-L Fuses
- **31 - CDS FAN 30 Amp** Electric Cooling Fans
- **32 - RDI FAN 30 Amp** Electric Cooling Fans
- **33 - PWR 30 Amp** Power Door Lock System, Electric Moon Roof, Power Windows
- **34 - ABS 50 Amp** Anti-Lock Brake System
- **35 - MAIN 80 Amp** IGN, HAZ, DOME, ALT-S, MAIN No.1, AM2, & EFI Fuses
- **36 - ALT 100 Amp** HTR, ABS, RDI FAN, CDS FAN, CIG, SRS-ACC, WIPER, ECU-IG, TURN & GAUGE, DEFOG, TAIL, STOP, HORN, OBD, SRS-B, PWR OUTLET, PWR, & AM1 Fuses
- **37 - HTR 50 Amp** Air Conditioning System, A/C Fuse